

Statutory Licensing Sub-Committee

20th December 2016

Application for the variation of a Premises Licence



Report of Jane Robinson, Corporate Director, Adult & Health Services

Name and Address of Premises: McColls 1-2 Shirley Terrace, Evenwood, Bishop Auckland, DL14 9RB

1. Summary

The Sub-Committee is asked to consider and determine the application for the variation of a premises licence received from:

Martin McColl Ltd
Martin McColl House
Ashwells Road
Brentwood
Essex CM15 9ST

A plan showing the location of the premises is attached at Appendix 1.

2. Details of the Application

An application for the variation of a premises licence was received by the Licensing Authority on 7th November 2016. A copy of the application is attached as Appendix 2.

The application is deemed by the Licensing Authority to be correctly served.

The application is in respect of the following licensable activities and for the hours detailed:

Activities	Days & Hours Requested
PROPOSED Sale of Alcohol (on & off sales) And Opening Hours	PROPOSED Monday to Sunday 06:00 hrs to 23:00 hrs To remove seasonal restrictions on the sale of alcohol below
CURRENT Sale of Alcohol (on & off sales) And Opening Hours	CURRENT Monday to Saturday 08:00 hrs to 23:00 hrs Sunday 10:00 hrs to 22:20 hrs Seasonal - Sale of alcohol, Good Friday 08:00 to 22:30 hrs, Christmas Day 12:00 to 15:00 hrs then 19:00 to 22:30 hrs

The applicant has proposed the steps that they intend to take in order to promote the four licensing objectives, which are outlined within the application form.

3. The Representations

The Licensing Authority received three letters of representation from 'other persons', Evenwood Parish Council, Cllr H Smith, Mr & Mrs Smith. The licensing authority consider the letters to be relevant.

The representation relates to the following licensing objective:

- The Prevention of Crime and Disorder
- The Prevention of Public Nuisance

Attached as Appendix 3.

4. Parties

The Parties to the hearing will be:

- Lockett & Co (Applicant's agent)
- Martin Clark – Evenwood Parish Council (Other person)
- Cllr Heather Smith (Other person)
- Mr & Mrs F Smith (Other persons)

5. Durham County Council Statement of Licensing Policy

The Sub-Committee's attention is drawn to the following relevant parts of the Policy:

- 7.0 Prevention of Crime and Disorder
- 9.0 Prevention of Public Nuisance
- Appendix B - Framework Licensing Hours

Relevant information is attached as Appendix 4.

6. Section 182 Guidance

The Sub-Committee's attention is drawn to the relevant parts of the Guidance issued under section 182 of the Licensing Act 2003 as follows:

- 2.1 – 2.5 Crime & Disorder
- 2.14 - 2.20 Public Nuisance

Relevant information is attached as Appendix 5.

7. For Decision

The Sub-Committee is asked to determine the application in light of the representations received.

Background Papers:

- Durham County Council's Statement of Licensing Policy
- Guidance issued under section 182 of the Licensing Act 2003 (as amended March 2015)

Contact: Karen Robson

Tel: 03000 265104

Email: karen.robson2@durham.gov.uk

APPENDIX 1 – LOCATION PLAN

Durham County Council - IntraMAP

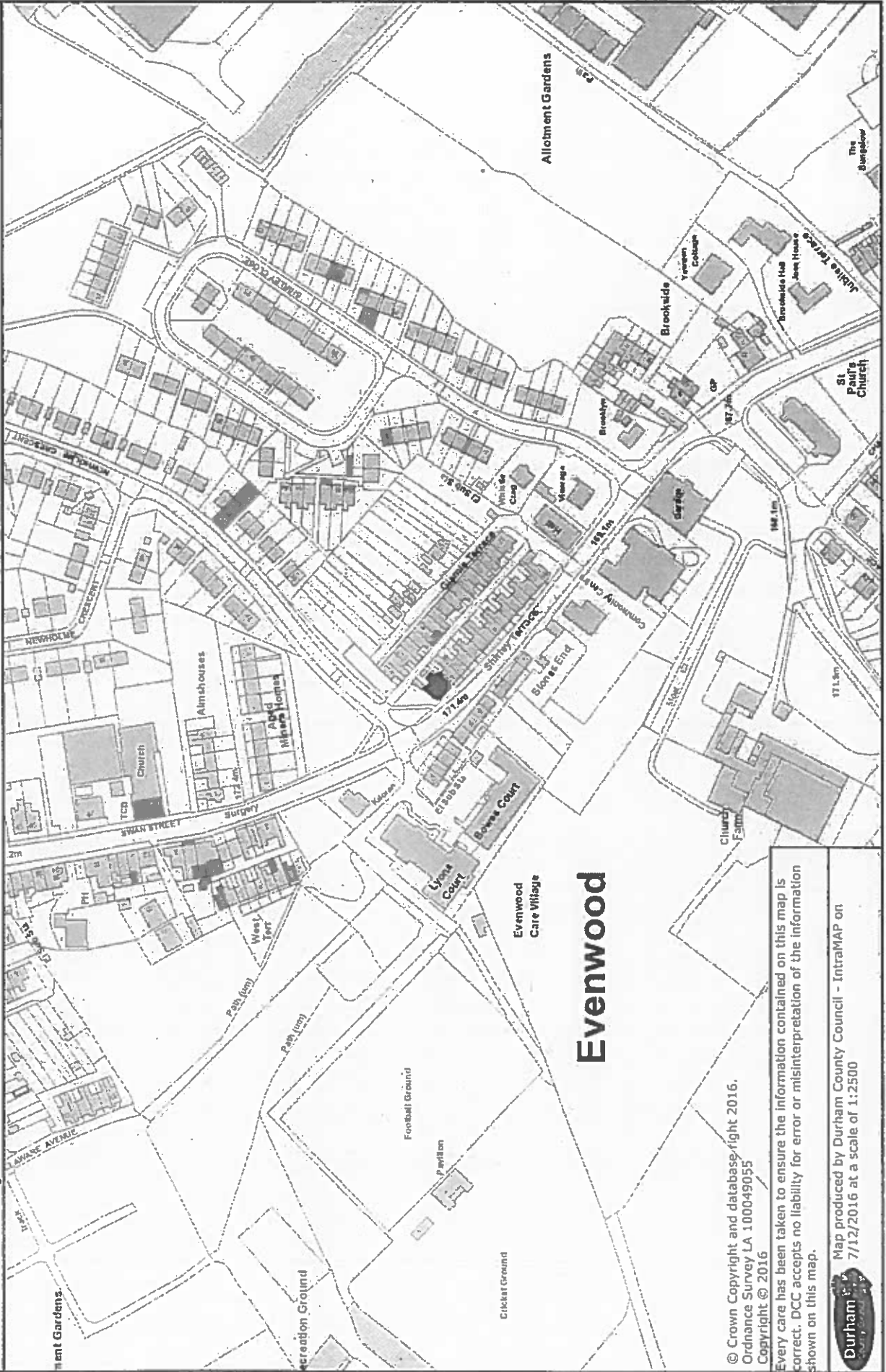

Evenwood

© Crown Copyright and database right 2016.
Ordnance Survey LA 100049055
Copyright © 2016
Every care has been taken to ensure the information contained on this map is correct. DCC accepts no liability for error or misinterpretation of the information shown on this map.

Map produced by Durham County Council - IntraMAP on
7/12/2016 at a scale of 1:2500



APPENDIX 2 – APPLICATION FORM AND CURRENT LICENCE



* required information

Section 1 of 17

You can save the form at any time and resume it later. You do not need to be logged in when you resume.

System reference This is the unique reference for this application generated by the system.

Your reference You can put what you want here to help you track applications if you make lots of them. It is passed to the authority.

Are you an agent acting on behalf of the applicant?

Yes No

Put "no" if you are applying on your own behalf or on behalf of a business you own or work for.

Applicant Details

* First name

* Family name

* E-mail

Main telephone number Include country code.

Other telephone number

Indicate here if the applicant would prefer not to be contacted by telephone

Is the applicant:

Applying as a business or organisation, including as a sole trader

Applying as an individual

A sole trader is a business owned by one person without any special legal structure. Applying as an individual means the applicant is applying so the applicant can be employed, or for some other personal reason, such as following a hobby.

Applicant Business

Is the applicant's business registered in the UK with Companies House? Yes No

Note: completing the Applicant Business section is optional in this form.

Registration number

Business name If the applicant's business is registered, use its registered name.

VAT number Put "none" if the applicant is not registered for VAT.

Legal status

Continued from previous page...

Applicant's position in the business

Home country

The country where the applicant's headquarters are.

Registered Address

Address registered with Companies House.

Building number or name

Street

District

City or town

County or administrative area

Postcode

Country

Agent Details

* First name

* Family name

* E-mail

Main telephone number

Include country code.

Other telephone number

Indicate here if you would prefer not to be contacted by telephone

Are you:

An agent that is a business or organisation, including a sole trader

A sole trader is a business owned by one person without any special legal structure.

A private individual acting as an agent

Agent Business

Is your business registered in the UK with Companies House? Yes No

Note: completing the Applicant Business section is optional in this form.

Registration number

Business name

If your business is registered, use its registered name.

VAT number

Put "none" if you are not registered for VAT.

Legal status

Continued from previous page...

Your position in the business LICENSING COMPLIANCE MANAGER

Home country United Kingdom

The country where the headquarters of your business is located.

Agent Registered Address

Address registered with Companies House.

Building number or name LOCKETT HOUSE

Street 13 CHURCH STREET

District

City or town KIDDERMINSTER

County or administrative area

Postcode DY10 2AH

Country United Kingdom

Section 2 of 17

APPLICATION DETAILS

This application cannot be used to vary the licence so as to extend the period for which the licence has effect or to vary substantially the premises to which it relates. If you wish to make that type of change to the premises licence, you should make a new premises licence application under section 17 of the Licensing Act 2003.

I/we, as named in section 1, being the premises licence holder, apply to vary a premises licence under section 34 of the Licensing Act 2003 for the premises described in section 2 below.

* Premises Licence Number PL(A)0069

Are you able to provide a postal address, OS map reference or description of the premises?

Address OS map reference Description

Postal Address Of Premises

Building number or name MCCOLLS

Street 1 & 2 SHIRLEY TERRACE

District EVENWOOD

City or town BISHOP AUCKLAND

County or administrative area

Postcode DL14 9RB

Country United Kingdom

Premises Contact Details

Telephone number

Continued from previous page...

Non-domestic rateable
value of premises (£)

5,600

Section 3 of 17

VARIATION

Do you want the proposed
variation to have effect as
soon as possible? Yes No

Do you want the proposed variation to have effect in relation to the
introduction of the late night levy?

Yes No

You do not have to pay a fee if the only
purpose of the variation for which you are
applying is to avoid becoming liable to the
late night levy.

If your proposed variation
would mean that 5,000 or
more people are expected to
attend the premises at any
one time, state the number
expected to attend

Describe Briefly The Nature Of The Proposed Variation

Describe the premises. For example the type of premises, its general situation and layout and any other information which could be relevant to the licensing objectives. Where your application includes off-supplies of alcohol and you intend to provide a place for consumption of these off-supplies, you must include a description of where the place will be and its proximity to the premises.

THE VARIATION LOOKS TO REMOVE THE SEASONAL RESTRICTIONS ON THE SALE OF ALCOHOL HOURS AND EXTEND THE SALE OF ALCOHOL HOURS TO 06:00 HOURS - 23:00 HOURS MONDAY TO SUNDAY FOR CONSUMPTION OFF THE PREMISE.

Section 4 of 17

PROVISION OF PLAYS

Will the schedule to provide plays be subject to change if this application to vary is successful?

Yes No

Section 5 of 17

PROVISION OF FILMS

Will the schedule to provide films be subject to change if this application to vary is successful?

Yes No

Section 6 of 17

PROVISION OF INDOOR SPORTING EVENTS

Will the schedule to provide indoor sporting events be subject to change if this application to vary is successful?

Continued from previous page...

Yes

No

Section 7 of 17

PROVISION OF BOXING OR WRESTLING ENTERTAINMENTS

Will the schedule to provide boxing or wrestling entertainments be subject to change if this application to vary is successful?

Yes

No

Section 8 of 17

PROVISION OF LIVE MUSIC

Will the schedule to provide live music be subject to change if this application to vary is successful?

Yes

No

Section 9 of 17

PROVISION OF RECORDED MUSIC

Will the schedule to provide recorded music be subject to change if this application to vary is successful?

Yes

No

Section 10 of 17

PROVISION OF PERFORMANCES OF DANCE

Will the schedule to provide performances of dance be subject to change if this application to vary is successful?

Yes

No

Section 11 of 17

PROVISION OF ANYTHING OF A SIMILAR DESCRIPTION TO LIVE MUSIC, RECORDED MUSIC OR PERFORMANCES OF DANCE

Will the schedule to provide anything similar to live music, recorded music or performances of dance be subject to change if this application to vary is successful?

Yes

No

Section 12 of 17

PROVISION OF LATE NIGHT REFRESHMENT

Will the schedule to provide late night refreshment be subject to change if this application to vary is successful?

Yes

No

Section 13 of 17

SUPPLY OF ALCOHOL

Will the schedule to supply alcohol be subject to change if this application to vary is successful?

Yes

No

Continued from previous page...

Standard Days And Timings

MONDAY

Start

End

Start

End

Provide timings in 24 hour clock (e.g., 16:00) and only give details for the days of the week when you intend the premises to be used for the activity.

TUESDAY

Start

End

Start

End

WEDNESDAY

Start

End

Start

End

THURSDAY

Start

End

Start

End

FRIDAY

Start

End

Start

End

SATURDAY

Start

End

Start

End

SUNDAY

Start

End

Start

End

Will the sale of alcohol be for consumption?

- On the premises Off the premises Both

If the sale of alcohol is for consumption on the premises select on, if the sale of alcohol is for consumption away from the premises select off. If the sale of alcohol is for consumption on the premises and away from the premises select both.

State any seasonal variations.

For example (but not exclusively) where the activity will occur on additional days during the summer months.

NONE.

Continued from previous page...

Non-standard timings. Where the premises will be used for the supply of alcohol at different times from those listed above, list below.

For example (but not exclusively), where you wish the activity to go on longer on a particular day e.g. Christmas Eve.

NONE.

Section 14 of 17

ADULT ENTERTAINMENT

Highlight any adult entertainment or services, activities, or other entertainment or matters ancillary to the use of the premises that may give rise to concern in respect of children.

Provide information about anything intended to occur at the premises or ancillary to the use of the premises which may give rise to concern in respect of children, regardless of whether you intend children to have access to the premises, for example (but not exclusively) nudity or semi-nudity, films for restricted age groups etc gambling machines etc.

NONE.

Section 15 of 17

HOURS PREMISES ARE OPEN TO THE PUBLIC

Standard Days And Timings

MONDAY

Start

End

Start

End

Provide timings in 24 hour clock (e.g., 16:00) and only give details for the days of the week when you intend the premises to be used for the activity.

TUESDAY

Start

End

Start

End

WEDNESDAY

Start

End

Start

End

THURSDAY

Start

End

Start

End

FRIDAY

Start

End

Start

End

Continued from previous page...

SATURDAY

Start

End

Start

End

SUNDAY

Start

End

Start

End

State any seasonal variations.

For example (but not exclusively) where the activity will occur on additional days during the summer months.

NONE.

Non standard timings. Where you intend to use the premises to be open to the members and guests at different times from those listed above, list below.

For example (but not exclusively), where you wish the activity to go on longer on a particular day e.g. Christmas Eve.

NONE.

Identify those conditions currently imposed on the licence which you believe could be removed as a consequence of the proposed variation you are seeking.

NONE.

- I have enclosed the premises licence
- I have enclosed the relevant part of the premises licence

Reasons why I have failed to enclose the premises licence or relevant part of premises licence.

ORIGINAL PREMISES LICENCE NOT YET RECEIVED FOLLOWING TRANSFER APPLICATION SUBMITTED ONLINE 07/11/16 TRANSFERRING THE LICENCE TO MARTIN MCCOLL LIMITED AND A DPS VARIATION APPLICATION SUBMITTED ONLINE 07/11/16.

Section 16 of 17

LICENSING OBJECTIVES

Describe the steps you intend to take to promote the four licensing objectives:

a) General – all four licensing objectives (b,c,d,e)

List here steps you will take to promote all four licensing objectives together.

Continued from previous page...

A CCTV system with recording facilities will be in place at site and will operate at all times the premise is open for licensable activities. Images will be retained for a minimum of 28 days and copies of the images can be made available upon reasonable request (meaning within 48 hours) by the Police or other relevant officers of a responsible authority.

Staff will be trained with regard to their responsibilities in the retail sale of alcohol and regular refresher training (every 6 months) will also be undertaken. Training records can be made available for inspection upon reasonable request (meaning within 48 hours) by the Police or other relevant officers of a responsible authority.

A till prompt system will be in operation at the store and used for the refusal of all age restricted products.

An electronic refusal log will be operated and maintained and will be produced to a relevant officer of the Police or other relevant officers of a responsible authority upon reasonable request (meaning within 48 hours).

A Challenge 25 policy will be operated at the premise; forms of identification that will be accepted are a valid passport, photo card driving licence and PASS accredited identification card.

The licence holder shall display prominent signage confirming the company's Challenge 25 policy.

Spirits will be located behind the counter.

b) The prevention of crime and disorder

A CCTV system with recording facilities will be in place at site and will operate at all times the premise is open for licensable activities. Images will be retained for a minimum of 28 days and copies of the images can be made available upon reasonable request (meaning within 48 hours) by the Police or other relevant officers of a responsible authority.

Spirits will be located behind the counter.

Staff will be trained with regard to their responsibilities in the retail sale of alcohol and regular refresher training (every 6 months) will also be undertaken. Training records can be made available for inspection upon reasonable request (meaning within 48 hours) by the Police or other relevant officers of a responsible authority.

c) Public safety

A CCTV system with recording facilities will be in place at site and will operate at all times the premise is open for licensable activities. Images will be retained for a minimum of 28 days and copies of the images can be made available upon reasonable request (meaning within 48 hours) by the Police or other relevant officers of a responsible authority.

d) The prevention of public nuisance

Staff will be trained with regard to their responsibilities in the retail sale of alcohol and regular refresher training (every 6 months) will also be undertaken. Training records can be made available for inspection upon reasonable request (meaning within 48 hours) by the Police or other relevant officers of a responsible authority.

e) The protection of children from harm

Staff will be trained with regard to their responsibilities in the retail sale of alcohol and regular refresher training (every 6 months) will also be undertaken. Training records can be made available for inspection upon reasonable request (meaning within 48 hours) by the Police or other relevant officers of a responsible authority.

A till prompt system will be in operation at the store and used for the refusal of all age restricted products.

Continued from previous page...

An electronic refusal log will be operated and maintained and will be produced to a relevant officer of the Police or other relevant officers of a responsible authority upon reasonable request.

A Challenge 25 policy will be operated at the premise; forms of identification that will be accepted are a valid passport, photo card driving licence and PASS accredited identification card.

The licence holder shall display prominent signage confirming the company's Challenge 25 policy.

Spirits will be located behind the counter.

Continued from previous page...

* Full name

* Capacity

* Date / /
dd mm yyyy

Once you're finished you need to do the following:

1. Save this form to your computer by clicking file/save as...
 2. Go back to <https://www.gov.uk/apply-for-a-licence/premises-licence/county-durham/change-1> to upload this file and continue with your application.
- Don't forget to make sure you have all your supporting documentation to hand.

IT IS AN OFFENCE, LIABLE ON SUMMARY CONVICTION TO A FINE NOT EXCEEDING LEVEL 5 ON THE STANDARD SCALE, UNDER SECTION 158 OF THE LICENSING ACT 2003, TO MAKE A FALSE STATEMENT IN OR IN CONNECTION WITH THIS APPLICATION

OFFICE USE ONLY

Applicant reference number

Fee paid

Payment provider reference

ELMS Payment Reference

Payment status

Payment authorisation code

Payment authorisation date

Date and time submitted

Approval deadline

Error message

Is Digitally signed

< Previous 1 2 3 4 5 6 7 8 9 10 11 12 13 14 15 16 17 Next >

LICENSING ACT 2003 PREMISES LICENCE

Premises Licence Number
Granted
Issued

PL(A)0069
24 November 2005
25 October 2011

Part 1 – Premises details

Postal address of premises, or if none, ordnance survey map reference or description	Issuing Authority
NISA LOCAL EVENWOOD 1-2 SHIRLEY TERRACE EVENWOOD BISHOP AUCKLAND DL14 9RB	DURHAM COUNTY COUNCIL EHCP LICENSING SERVICES PO BOX 617 DURHAM DH1 9HZ

Telephone number:

Where the licence is time limited the dates
N/A

Licensable activities authorised by this licence
Sale by Retail of Alcohol

The opening hours of the premises (all times in 24hr format)

Monday	08:00 - 23:00	Non standard/seasonal timings: Good Friday 08:00 - 22:30 Christmas Day 12:00 - 15:00 then 19:00 - 22:30
Tuesday	08:00 - 23:00	
Wednesday	08:00 - 23:00	
Thursday	08:00 - 23:00	
Friday	08:00 - 23:00	
Saturday	08:00 - 23:00	
Sunday	10:00 - 22:30	

Where the licence authorises the sale by retail of alcohol whether these are on and/or off sales
OFF ALCOHOL SALES ONLY

The times the licence authorises the carrying out of licensable activities (all in 24hr format)

Sale by retail of alcohol

Off sales only

Monday	08:00 - 23:00	Further details
Tuesday	08:00 - 23:00	N/A
Wednesday	08:00 - 23:00	
Thursday	08:00 - 23:00	Non standard/seasonal timings:
Friday	08:00 - 23:00	Good Friday 08:00 - 22:30
Saturday	08:00 - 23:00	Christmas Day 12:00 - 15:00 then 19:00 - 22:30
Sunday	10:00 - 22:30	

Part 2

Name, (registered) address, telephone number and email (where relevant) of holder of premises licence

MR MANNY HUSSAIN

Registered number of holder, for example company number, charity number (where applicable)

Company no: N/A

Charity no: N/A

Name, address and telephone number of designated premises supervisor where the premises licence authorises the sale by retail of alcohol

MR MANNY HUSSAIN

Personal licence number and issuing authority of personal licence held by designated premises supervisor where the premises licence authorises the sale by retail of alcohol

Annex 1 – Mandatory conditions

No supply of alcohol may be made at a time when no designated premises supervisor has been specified in the licence or at a time when the designated premises supervisor does not hold a personal licence or his or her licence has been suspended. Every supply of alcohol under this premises licence must be made or authorised by a person who holds a personal licence.

The premises licence holder shall ensure that an age verification policy applies to the premises in relation to the sale or supply of alcohol: -

The policy must require individuals who appear to the responsible person to be under 18 years of age (or such older age as may be specified in the policy) to produce on request, before being served alcohol, identification bearing their photograph, date of birth and a holographic mark.

Mandatory condition: embedded restrictions

This Premises Licence has been granted upon conversion under schedule 8 of the Licensing Act 2003 of the previous Justices' On Licence, and such rights and restrictions that applied to such Licence are hereby incorporated into this Premises Licence, subject to any express terms to the contrary hereinafter specified, and/or any restriction applying to a Premises Licence and/or any licensable activity.

Annex 2 – Conditions consistent with the premises Operating Schedule

General

N/A

The Prevention of Crime and Disorder

N/A

Public Safety

N/A

The Prevention of Public Nuisance

N/A

The Protection of Children from Harm

N/A

Annex 3 – Conditions attached after a hearing by the licensing authority

None

Annex 4 – Plans attached

Attached

Signature of Authorised Officer
Head of Environment, Health and Consumer Protection

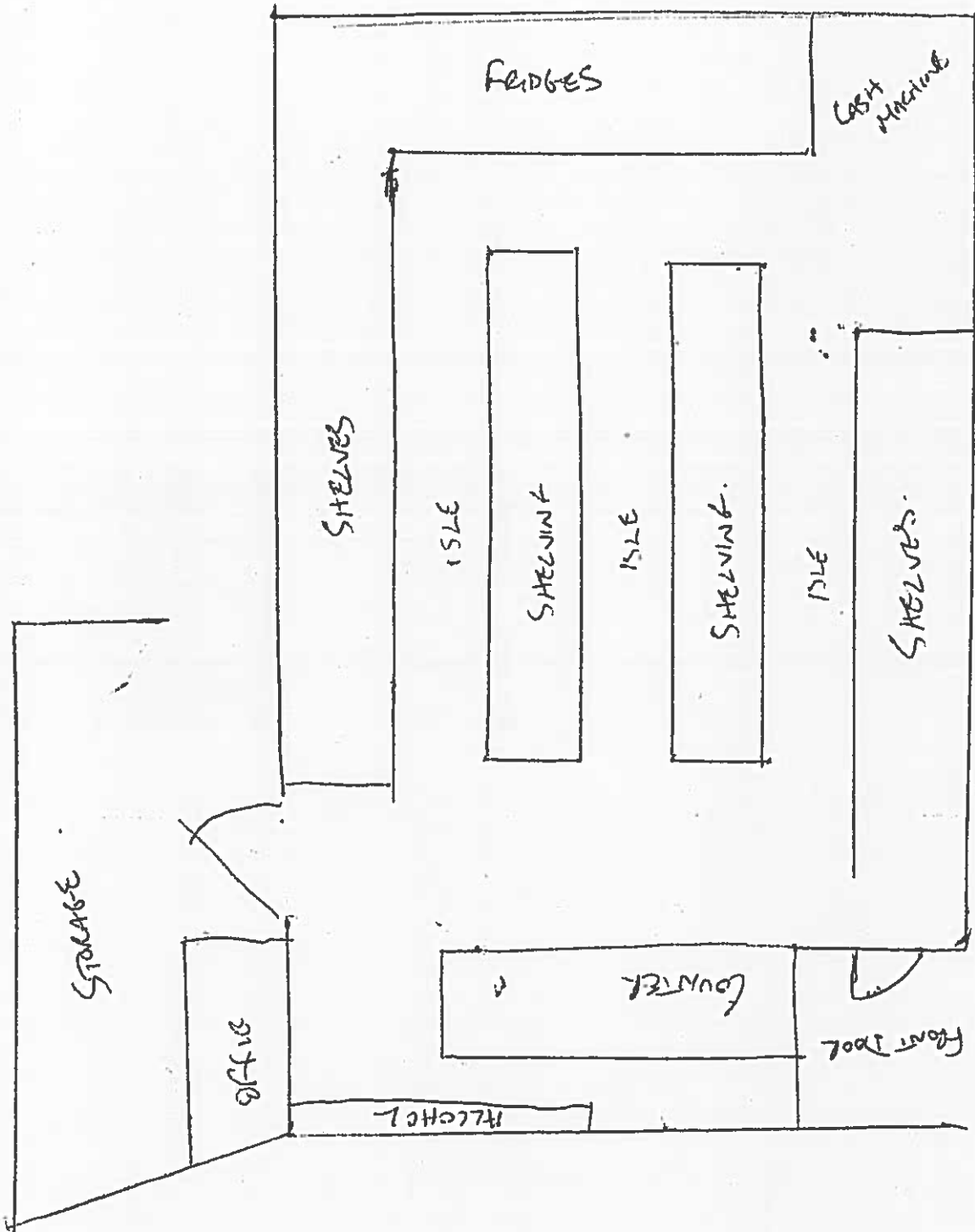

APPENDIX 3 – LETTERS OF REPRESENTATION

From: evenwoodparish@aol.com [mailto:evenwoodparish@aol.com]
Sent: 09 November 2016 19:14
To: Carol Graham - Licensing Assistant (N'hoods)
Subject: Licensing - variation application - McColls, 1-2 Shirley Terrace, Evenwood

Dear Ms Graham

The Parish Council were copied into this variation application and discussed it at its meeting on the 8th November. The parish council know that it is not a statutory consultee but wanted to make the following comments and hopes they would be taken into consideration:

Members were concerned over the extended hours, especially the need to sell alcohol at 6am in the morning. The current hours on the application were incorrect as the old Nisa shop opened from 7am and closed at 9pm and not as stated. Traffic issues (congestion due to parking) around the shop have increased in the area since the post office was located in the shop, and extending the hours would increase this. There was a concern regarding increases in anti-social behaviour as young people congregated outside the open shop. Members also felt the residents nearby should be consulted before any decision is made as they would be directly affected.

Yours sincerely

Martin Clark MILCM
Parish Clerk

www.evenwoodbaronypc.org.uk

From: Cllr Heather Smith

Sent: 09 November 2016 09:19

To: Carol Graham - Licensing Assistant (N'hoods)

Subject: RE: Licensing - variation application received - McColts, 1-2 Shirley Terrace, Evenwood, Bishop Auckland

Hi Carol

I would have great concerns if this shop really intends to sell alcohol from 6am to 23.00. Despite the previous license to 22.00 in fact the shop has been closing at 9pm under the previous ownership. This shop is a major source of traffic congestion in the village due to the number of customers' cars that park on both sides of the road. Extending the licensing hours will exacerbate this. There is also a problem with antisocial behaviour in the village which is often alcohol fuelled and I would not support anything that makes alcohol easier to obtain in the village. Who needs to buy alcohol at 6am?

I attended the meeting of Evenwood and Barony parish council last night and there was universal opposition to extending the licensing hours for this shop.

Thanks

Heather Smith

MR. & MRS. F. SMITH

GLAMIS TERRACE,

02 DEC 2016

EVENWOOD

CO. DURHAM

DL14 9RD

30/11/16

DEAR SIR/MADAM,

We are writing to object to the extended hours to sell alcohol at - McColls, Shirley Terrace, Evenwood, which is our local village shop.

We live just behind the shop and are concerned that things will go from bad to worse. We were constantly picking bottles and cans up off the village green and in our garden. We did complain to the local police, as there were gangs of youths from other villages congregating at the side of the shop, which during opening hours on a night is floodlit from the light on the shop sign. The police asked us to keep any cans or bottles as they could get the bar code from them to prove

where they had come from.

We would not like this to happen again or escalate if the opening hours are extended.

These village shops are becoming mini-supermarkets and we already have to put up with heavy goods wagons (some of which are 17½ ton) delivering from 6.30am onwards everyday. We have already had our garden wall damaged on three separate occasions.

The parking is horrendous and sometimes we can't get out of our own drive. We feel that we put up with enough now without further extensions of opening hours.

To one side of the shop are pensioners bungalows and we feel that we need to speak for those people as well.

The shop is essential for the village but not to sell alcohol at these extended times. After all alcohol is not perishable and could be bought within the existing times.

The new owners, McCall's are already opening earlier and closing later than the previous owners which were NISA.

Yours faithfully

(ANN SMITH)

FRED SMITH

**APPENDIX 4 – STATEMENT OF LICENSING POLICY
CRIME & DISORDER and PUBLIC NUISANCE
FRAMEWORK OF LICENSING HOURS**

DURHAM COUNTY COUNCIL STATEMENT OF LICENSING POLICY

7.0 The Prevention of Crime and Disorder

7.1 Licensed premises, especially those offering late night / early morning entertainment, alcohol and refreshment may sometimes, if not properly managed, become a source of public nuisance, generating crime and disorder problems.

7.2 As a matter of policy, the Licensing Authority will require every holder of a premises licence, club premises certificate or temporary event notice to be responsible for minimising the impact of crime, disorder and anti-social behaviour by their patrons both on and within the immediate vicinity of their premises, including for example on the pavement, in a beer garden or in a smoking shelter.

7.3 The Licensing Authority recommends that all applicants demonstrate in their Operating Schedules that suitable and sufficient measures, ranging from the design and layout of the premises through to the daily operation of the business have been identified and will be implemented and maintained with the intention of preventing crime and disorder. Procedures to deal with drunken customers, violence and anti social behaviour in and outside premises and the provision of closed circuit television in certain premises should be considered by applicants, licensees and event organisers when addressing this issue.

7.4 The Licensing Authority encourages Personal Licence holders to actively participate in established "Pubwatch" schemes, where issues relating to crime and disorder can be addressed. The Licensing Authority support involvement in "Best Bar None" initiative which enables premises to demonstrate good safe operating procedures. Such schemes have been very successful in reducing the negative impact of alcohol across a range of circumstances.

7.5 The Licensing Authority recognises and promotes effective and responsible management of all licensed and authorised premises through competent and efficient and regular instruction, recorded training, supervision of staff and the adoption of good practice, such as 'Challenge 25'. These are considered to be among the most important control measures for the achievement of all Licensing Objectives. The Licensing Authority will take a positive view of anyone who invests in appropriate training, and in particular nationally accredited qualifications tailored to the Licensing sector. Training records should be kept available for inspection by all enforcement agencies.

7.6 The application for premises licence must identify a Designated Premises Supervisor (DPS) who must also hold a Personal Licence. The DPS does not have to be present on the premises at all times when alcohol is being sold. However, the DPS and Premises Licence Holder remain responsible for the premises at all times. It is important that there is an accountable, responsible person present when alcohol is being sold or supplied to ensure, for example, that alcohol is not sold to persons who have had too much to drink, or to those under the age of 18 years.

7.7 Someone should always be present on premises or at an event during times when licensable activities are taking place who can discuss any problems or

issues arising from the licensable activities offered on the premises with officers from Licensing Authority and Police. The Licensing Authority considers it to be good practice if the DPS or Premises Licence Holder is present in the licensed area of the premises:

- Between 22:00 hours and closing time, when the premises is one that regularly opens after midnight for both regulated entertainment and the sale or supply of alcohol for consumption on the premises.
- At all times when the premises is a "vertical drinking establishment" where little or no seating is provided.
- At times where there is a substantial increase in customers i.e. for televised major sporting events etc.

7.8 The Licensing Authority will only impose a maximum number of people that can attend premises or an event where there is a clear and justifiable need in respect of that particular premises or event. Any such decision will be based on the nature and style of the operation. The Licensing Authority will consider information provided by the applicant and any other body, in particular the Council's Building Control Section, Environmental Health Section and the Durham and Darlington Fire and Rescue Service before setting a maximum number. Applicants will be expected to detail the arrangements that would be put in place e.g. provision of door staff to ensure that the permitted number of people attending the premises or event will not be exceeded.

7.9 Whenever security operatives/door supervisors are employed at licensed premises to carry out security functions they must be licensed by the Security Industry Authority (SIA). If a licensee directly employs security operatives they will need to be licensed by the SIA as a supervisor/manager.

7.10 The numbers of licensed door supervisors, both male and female, required at any premises will be dependent upon the nature of the activities licensed and the characteristics and capacity of the establishment and hours of trading.

7.11 In addition to the requirement of the Licensing Authority to promote the Licensing Objectives, the Council also has a duty under Section 17 of the Crime and Disorder Act 1998 to do all it reasonably can do to prevent crime and disorder in its area and to consider crime and disorder in its decision making process.

7.12 Toughened/Safety Glass Policy: Licensed venues that provide the sale or supply of alcohol for consumption on the premises should consider the introduction of toughened/safety glass. This policy expectation applies to those premises that would be considered as carrying a higher risk for potential crime and disorder. In particular it is expected in premises considered to be high volume vertical drinking establishments and those premises open beyond midnight in areas where there is a high concentration of venues (but not premises in those areas that are viewed as low risk in this context).

7.13 Drugs/Knives/Weapons: The Licensing Authority will expect licensees to take all reasonable steps to prevent the presence of drugs on licensed premises and to take appropriate steps to prevent drugs changing hands within the

premises in order to prevent tragedies as a result of drug misuse. The Licensing Authority will expect licensees to be familiar with the Home Office Drug Strategy booklet entitled Safer Clubbing (ISBN 1840827807) or other subsequent editions. The Licensing Authority also expects that licence holders will also take steps to prevent the presence of knives and other weapons on their premises and that a log be kept of all drug, knife and weapon incidents. Licence holders should also consider arranging training for their staff on drugs, knives and weapons and to have policies for dealing with the possession of drugs, knives and weapons and the supply of drugs.

DURHAM COUNTY COUNCIL STATEMENT OF LICENSING POLICY

9.0 Prevention of Public Nuisance

9.1 Licensed premises, especially those operating late at night and in the early hours of the morning, can cause a range of nuisances impacting on people living, working or sleeping in the vicinity of the premises.

9.2 The concerns relate, amongst other things, to litter, light pollution, noxious odours and noise nuisance resulting from music, human voices, ventilation equipment and vehicles. The Licensing Authority will expect applicants to demonstrate that suitable and sufficient measures have been identified, and will be implemented and maintained, with the intention of preventing public nuisance relevant to the individual style, location and characteristics of the premises and events.

9.3 If an external structure or area is to be used by customers, whether for consumption of alcohol or for smoking, the applicant will be expected to offer measures designed to minimise its impact on local residents in respect of both public nuisance and crime and disorder. These measures may include a restriction on hours that areas / structures will be used, appropriate signage requesting customers to consider local residents and monitoring of such areas by staff.

9.4 The placement of tables and chairs outside of licensed premises may give rise to public nuisance including noise and litter. When tables and chairs are situated on the public highway relevant consents will often be required. Enquiries for such consents should be made to the Council's Highway's Section of the Regeneration and Economic Development Department. In predominantly commercial areas such as shopping centres the Licensing Authority, the use of tables and chairs outside may be allowed however, the Council will normally expect them to be removed before the premises close, and any resulting litter/ debris cleared away.

9.5 Applicants should give consideration to reducing potential noise nuisance by, for example (this list is not exhaustive):

- Assessment of likely noise levels in the premises.
- Assessment of likely noise levels if outdoor drinking is allowed.
- The sound insulation the building would provide (e.g. double glazing, double doors / lobbies to entrances, windows used for ventilation).
- The distance and direction to the nearest noise sensitive premises.
- Likely noise sources outside of the premises (e.g. emptying bottle bins, taxis, unruly customers leaving the premises).
- Dispersal of patrons – where necessary the Licensing Authority will expect a dispersal policy for patrons at the end of the evening. The policy will specify such issues as alterations to the style and volume of music played, public address announcements and use of appropriate signage at exits.
- Ways to limit noise / disorder from patrons leaving the premises.

9.6 The extent to which the above matters will need to be addressed will be dependent on the nature of the area where the premises are situated, the type of

premises concerned, the licensable activities to be provided, operational procedures and the needs of the local community.

9.7 Applicants are advised to seek advice from Durham County Councils Environmental Health Team and incorporate any recommendations in their Operating Schedule before submitting their applications.

9.8 Takeaways and fast-food outlets: The Licensing Authority expects takeaways and late night refreshment premises to take reasonable steps in clearing litter from outside their premises and along the pavement in either direction as necessary, whilst the premises are open and at the end of the working day. These premises should maintain clean, dirt or grease free frontages. Such premises should also provide notices displayed advising customers of the location of bins and patrons should use the bins any provided.

Appendix B. Framework Licensing Hours - recommended hours for the operation of licensable activities (the sale of alcohol and the provision of late night refreshment) for categories of licensed premises situated within the County of Durham.

Category of Premise	Weekdays (Sunday to Thursday)	Weekends (Friday night into Saturday morning and Saturday night into Sunday morning)	Bank Holidays
For premises licences and club premises certificates authorising the sale or supply of alcohol for consumption on or off the premises	07.00 to 00.00	07.00 to 01.00	<p>Good Friday Plus 1 Hour</p> <p>For all other bank holidays, an additional hour be added to the terminal hour of the day preceding the bank holiday</p> <p>(i.e. if the Monday is the bank holiday, the Sunday is normal trading plus 1 hour).</p>
For licences not including the sale or supply of alcohol	07.00 to 23.30	07.00 to 00.30	<p>Good Friday Plus 1 Hour</p> <p>For all other bank holidays, an additional hour be added to the terminal hour of the day preceding the bank holiday</p> <p>(i.e. if the Monday is the bank holiday, the Sunday is normal trading plus 1 hour).</p>
For licences not including the sale or supply of alcohol (community centres, village halls)	07.00 to 00.00	07.00 to 01.00	<p>Good Friday Plus 1 Hour</p> <p>For all other bank holidays, an additional hour be added to the terminal hour of the day preceding the bank holiday</p>

			(i.e. if the Monday is the bank holiday, the Sunday is normal trading plus 1 hour).
For licences authorising late night refreshment as the primary licensable activity (takeaways)	01.00	02.00	<p>Good Friday Plus 1 Hour</p> <p>For all other bank holidays, an additional hour be added to the terminal hour of the day preceding the bank holiday</p> <p>(i.e. if the Monday is the bank holiday, the Sunday is normal trading plus 1 hour).</p>

**APPENDIX 5 – SECTION 182
CRIME & DISORDER and PUBLIC NUISANCE**

S182 GUIDANCE – CRIME AND DISORDER

2.1 Licensing authorities should look to the police as the main source of advice on crime and disorder. They should also seek to involve the local Community Safety Partnership (CSP).

2.2 In the exercise of their functions, licensing authorities should seek to co-operate with the Security Industry Authority ("SIA") as far as possible and consider adding relevant conditions to licences where appropriate. The SIA also plays an important role in preventing crime and disorder by ensuring that door supervisors are properly licensed and, in partnership with police and other agencies, that security companies are not being used as fronts for serious and organised criminal activity. This may include making specific enquiries or visiting premises through intelligence led operations in conjunction with the police, local authorities and other partner agencies. Similarly, the provision of requirements for door supervision may be appropriate to ensure that people who are drunk, drug dealers or people carrying firearms do not enter the premises and ensuring that the police are kept informed.

2.3 Conditions should be targeted on deterrence and preventing crime and disorder. For example, where there is good reason to suppose that disorder may take place, the presence of closed-circuit television (CCTV) cameras both inside and immediately outside the premises can actively deter disorder, nuisance, anti-social behaviour and crime generally. Some licence holders may wish to have cameras on their premises for the prevention of crime directed against the business itself, its staff, or its customers. But any condition may require a broader approach, and it may be appropriate to ensure that the precise location of cameras is set out on plans to ensure that certain areas are properly covered and there is no subsequent dispute over the terms of the condition.

2.4 The inclusion of radio links and ring-round phone systems should be considered an appropriate condition for public houses, bars and nightclubs operating in city and town centre leisure areas with a high density of licensed premises. These systems allow managers of licensed premises to communicate instantly with the police and facilitate a rapid response to any disorder which may be endangering the customers and staff on the premises.

2.5 Conditions relating to the management competency of designated premises supervisors should not normally be attached to premises licences. It will normally be the responsibility of the premises licence holder as an employer, and not the licensing authority, to ensure that the managers appointed at the premises are competent and appropriately trained. The designated premises supervisor is the key person who will usually be responsible for the day to day management of the premises by the premises licence holder, including the prevention of disorder. A condition of this kind may only be justified as appropriate in rare circumstances where it can be demonstrated that, in the circumstances associated with particular premises, poor management competency could give rise to issues of crime and disorder and public safety.

S182 GUIDANCE-- PUBLIC NUISANCE

2.14 The 2003 Act enables licensing authorities and responsible authorities, through representations, to consider what constitutes public nuisance and what is appropriate to prevent it in terms of conditions attached to specific premises licences and club premises certificates. It is therefore important that in considering the promotion of this licensing objective, licensing authorities and responsible authorities focus on the effect of the licensable activities at the specific premises on persons living and working (including those carrying on business) in the area around the premises which may be disproportionate and unreasonable. The issues will mainly concern noise nuisance, light pollution, noxious smells and litter.

2.15 Public nuisance is given a statutory meaning in many pieces of legislation. It is however not narrowly defined in the 2003 Act and retains its broad common law meaning. It may include in appropriate circumstances the reduction of the living and working amenity and environment of other persons living and working in the area of the licensed premises. Public nuisance may also arise as a result of the adverse effects of artificial light, dust, odour and insects or where its effect is prejudicial to health.

2.16 Conditions relating to noise nuisance will usually concern steps appropriate to control the levels of noise emanating from premises. This might be achieved by a simple measure such as ensuring that doors and windows are kept closed after a particular time, or persons are not permitted in garden areas of the premises after a certain time. More sophisticated measures like the installation of acoustic curtains or rubber speaker mounts to mitigate sound escape from the premises may be appropriate. However, conditions in relation to live or recorded music may not be enforceable in circumstances where the entertainment activity itself is not licensable (see chapter 15). Any conditions appropriate to promote the prevention of public nuisance should be tailored to the type, nature and characteristics of the specific premises and its licensable activities. Licensing authorities should avoid inappropriate or disproportionate measures that could deter events that are valuable to the community, such as live music. Noise limiters, for example, are expensive to purchase and install and are likely to be a considerable burden for smaller venues.

2.17 As with all conditions, those relating to noise nuisance may not be appropriate in certain circumstances where provisions in other legislation adequately protect those living in the area of the premises. But as stated earlier in this Guidance, the approach of licensing authorities and responsible authorities should be one of prevention and when their powers are engaged, licensing authorities should be aware of the fact that other legislation may not adequately cover concerns raised in relevant representations and additional conditions may be appropriate.

2.18 Where applications have given rise to representations, any appropriate conditions should normally focus on the most sensitive periods. For example, the most sensitive period for people being disturbed by unreasonably loud music is at night and into the early morning when residents in adjacent properties may be attempting to go to sleep or are sleeping. This is why there is still a need for a licence for performances of live music between 11 pm and 8 am. In certain circumstances, conditions relating to noise emanating from the premises may also be appropriate to address any disturbance anticipated as customers enter and leave.

2.19 Measures to control light pollution will also require careful thought. Bright lighting outside premises which is considered appropriate to prevent crime and disorder may itself give rise to light pollution for some neighbours. Applicants, licensing authorities and responsible authorities will need to balance these issues.

2.20 Beyond the immediate area surrounding the premises, these are matters for the personal responsibility of individuals under the law. An individual who engages in anti-social behaviour is accountable in their own right. However, it would be perfectly reasonable for a licensing authority to impose a condition, following relevant representations, that requires the licence holder or club to place signs at the exits from the building encouraging patrons to be quiet until they leave the area, or that, if they wish to smoke, to do so at designated places on the premises instead of outside, and to respect the rights of people living nearby to a peaceful night.